

## Insulated Jumpers

Insulated bypass jumper sets consist of three basic components: one pair of clamps, one pair of ferrules, and length of insulated cable. When a custom jumper is required, follow this procedure to ensure that a complete and functional jumper is specified.

### Insulated Jumper Checklist

1. Specify the style of insulated clamps. All of the clamps are hand installed wearing rubber insulating gloves, accept either shrouded or unshrouded ferrules, and accept insulated cable up to 4/0, 35kV. Insulated jumper clamps are sold in pairs.
2. Specify the size and length of insulated cable. We offer 15kV from #2 to 4/0. 25 and 35kV cable are both available in sizes 1/0 and 2/0. Be sure to specify the length of the cable chosen.
3. Specify the size and style of ferrules required. The size of the ferrule will be determined by the size of the cable. Specify the appropriate ferrule catalog number for either shrouded or unshrouded ferrules. Both types are sold in pairs.
4. Specify if there are any special requirements. This could include heat shrink tubing, special assembly instructions, markings, packaging etc.

### SALCOR Insulated Jumper Clamps



2260



2270

SALCOR Jumper Clamps are available in two main line sizes with a maximum use voltage of 35kV

Cat #	Main Line Range	Max Amps Continuous	Rating	OAL Length	Weight ea lbs.
2260	477 MCM	400	36kV	11.5"	4.8
2270	954 MCM	400	21kV	11.5	5.9

## Clear Plastic Insulated Jumper Clamps



2115



1785

**Clear Plastic Jumper Clamps** are available in two main line sizes with a maximum use voltage of 35kV. These clamps are compact, lightweight, and virtually unbreakable. The transparency allows easy inspection of the ferrule and cable inside of the handle. The body and jaw are made of a copper base alloy. The lower floating ring contact is bronze.

Cat #	Main Line Range	Max Amps Continuous	Rating	OAL Length	Weight ea lbs.
1785	477 MCM	400	36kV	11.5"	3.9
2115	954 MCM	400	21kV	11.5	4.9

### Flexible Jumper Cable

15kV

25kV

35kV

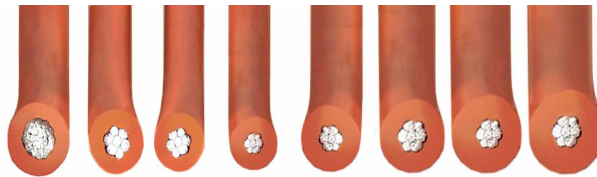

4/0 2/0 1/0 #2 1/0 2/0 1/0 2/0

\*\*\*See Cable Rating Chart on Next Page\*\*\*

**Flexible Insulated Jumper Cables** are lightweight and resistant to oil, heat, moisture, ozone and abrasion. The cable is embossed with conductor size and kV rating.

Cat #	Size	kV Rating	Nominal to ground	Str. Dia	O.A. Dia.	Max Amps	Weight per 1000 Lbs	Weight per 1000 kgs
2754	#2	15	10	.320	.75	200	440	199
2755	1/0	15	10	.403	.83	250	600	272
2756	2/0	15	10	.456	.90	300	710	322
2757	4/0	15	10	.592	1.01	400	1050	476
21300	1/0	25	15	.403	1.06	250	650	295
21060	2/0	25	15	.456	1.10	300	750	341
2059	1/0	35	20	.403	1.22	250	950	431
4370	2/0	35	20	.480	1.31	300	1060	482

### Ferrules

Ferrules are manufactured in two different styles, unshrouded and shrouded. Shrouded ferrules are compressed on both the conductor and the insulating jacket of the high voltage jacket to reduce bending stress. Shrouded ferrules are designed to be used on glove-installed high voltage jumpers. Unshrouded ferrules are crimped to the conductor stands only and can be used on either stick or glove installed jumpers. The continuous current rating is 400 Amps.



**Aluminum and Copper Ferrules Available**

### Grounding Equipment

A grounding jumper in its basic form consists of two clamps, one pair of ferrules and a length of cable.

#### Clamps

Clamps can be identical to each other or quite different depending on each grounding application. Because of this, ground clamps are sold individually, not in pairs. Types of clamps available include:

C-clamps, flat jaw clamps, socket clamps, duckbill clamps and specialty clamps for unique situations. Clamps are offered in bronze or aluminum alloy. Clamps meet all current specifications of ASTM F855.

#### Ground Set Checklist

1. Specify the clamps. Two are required for a complete ground. The maximum amperage of the clamp is designated by the ASTM grade of each clamp. Be sure that the clamp will meet or exceed the maximum amperage rating of the ground cable that it will be used with.
2. Specify the cable. Once the short circuit capacity of the system has been determined, choose the appropriate size cable. Specify the cable length, and the color of the jacket desired.
3. Specify the ferrules. One pair of ferrules is required per ground. The size of the ferrule must match the size of the cable that it will be used with. Specify whether copper or aluminum, and threaded or plain plug.
4. Specify the options. List any optional equipment that is desired. This can include hanger studs, contact studs, heat shrink tubing, marking, clear strain relief, etc.

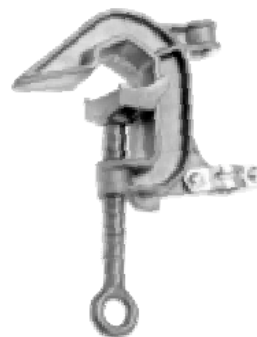

**C600-2271** Bronze Body, Smooth Jaws, Bronze Eye Screw Threaded Type



**T600-0790** Bronze Body, Smooth Jaws, Bronze T-Handle/Eyescrew, Threaded Type



**T600-0465** Bronze Body, Smooth Jaws, Bronze Eye screw, Threaded Type



**C600-1754** Aluminum Body, Smooth Jaws, Bronze Eyescrew, Threaded Type



**C600-2275** Aluminum Body, Smooth Jaws, Bronze Eyescrew Pressure Type. (Also Available with Serrated Jaws)



**C600-1743** Aluminum Body, Smooth Jaws Bronze Eyescrew, Threaded type



**G3369** Aluminum Body, Smooth Jaws, Bronze Eyescrew, Pressure Type



**C600-0337** Aluminum Body, Smooth Jaws, Bronze Eyescrew, Pressure Type

**Bus-Bar Clamps**



**C600-2281** Aluminum Body, Smooth Jaws, Bronze Eyescrew. Pressure Type (Also Available with Serrated Jaws)



**C600-2255** Aluminum Body, Smooth Jaws, Bronze Eyescrew, Threaded Type (Also Available with Serrated Jaws)

**Snap-On (Duckbill) Clamps**



**G3622-1** Aluminum Body, Smooth Jaws, Bronze Eyescrew, Pressure Type (Also Available in Threaded Type)



**G1810-2** Aluminum Body, Bronze Upper Jaw, Smooth Jaws, Bronze Eyescrew, Pressure Type (Also Available in Threaded Type)



**C600-1733** Aluminum Body, Smooth Jaws, Bronze Eyescrew, Threaded Type



**C600-0375** Aluminum Body, Serrated Jaws, Bronze Eyescrew Double Threaded.



**T600-0806** Aluminum Body, Serrated Jaws, Bronze Eyescrew Pressure Type

Electrical Ratings			
Cat #	C600-2271	T600-0790	T600-0465
Continuous Current Amps	400	200	200
Fault Current 15 Cycles	43,000	21,500	21,500
Fault Current 30 Cycles	30,000	15,000	15,000
Mechanical Ratings			
Recommended Torque in lbs	350	200	200
Main Line Range Max.	1.25"	0.814"	0.814"
Main Line Range Min.	0.162"	0.162"	0.162"
Jumper Range Max.	4/0 Ground	1/0 Ground	1/0 Ground
Jumper Range Min.	#2 Ground	#2 Ground	#2 Ground
Weight Each lbs	2.0	1.5	1.5
ASTM Designation	Type 1 Cl. A Grade 5	Type 1 Cl. A Grade 2	Type 1 Cl. A Grade 2

Electrical Ratings			
Cat #	C600-1754	C600-2275	C600-1743
Continuous Current Amps	350	400	400
Fault Current 15 Cycles	28,000	43,000	43,000
Fault Current 30 Cycles	20,000	30,000	30,000
Mechanical Ratings			
Recommended Torque in lbs	250	250	250
Main Line Range Max.	0.998"	1.25"	1.5"
Main Line Range Min.	0.128"	0.128"	0.162"
Jumper Range Max.	2/0 Ground	4/0 Ground	4/0 Ground
Jumper Range Min.	#2 Ground	#2 Ground	#2 Ground
Weight Each lbs	1	1.25	1.5
ASTM Designation	Type 1 Cl. A Grade 3	Type 1 Cl. A Grade 5	Type 1 Cl. A Grade 5

Electrical Ratings			
Cat #	C600-2281	C600-2255	C600-1733
Continuous Current Amps	400	400	400
Fault Current 15 Cycles	43,000	43,000	43,000
Fault Current 30 Cycles	30,000	30,000	30,000
Mechanical Ratings			
Recommended Torque in lbs	250	250	250
Main Line Range Max.	2" O.D. Bus	2" O.D. Bus	2.5" O.D
Main Line Range Min.	0.162"	0.162"	0.232"
Jumper Range Max.	4/0 Ground	4/0 Ground	4/0 Ground
Jumper Range Min.	#2 Ground	#2 Ground	#2 Ground
Weight Each lbs	2	1.75	2.37
ASTM Designation	Type 1 Cl. A Grade 5	Type 1 Cl. A Grade 5	Type 1 Cl. A Grade 5

Electrical Ratings			
Cat #	C600-0375	G3369	C600-0337
Continuous Current Amps	400	400	400
Fault Current 15 Cycles	70,000	43,000	43,000
Fault Current 30 Cycles	50,000	30,000	30,000
Mechanical Ratings			
Recommended Torque in lbs	300	300	300
Main Line Range Max.	3"	4" x 4" Sq.	6.375
Main Line Range Min.	0.5"	0.368"	3.5"
Jumper Range Max.	4/0 Ground	4/0 Ground	4/0 Ground
Jumper Range Min.	#2 Ground	#2 Ground	#2 Ground
Weight Each lbs	3	5.25	6
ASTM Designation	Type 1 Cl. B Grade 7	Type 1 Cl. A Grade 5	Type 1 Cl. A Grade 6

**There are many other clamps available.  
Call us for additional information.**

**You can also check out our website  
[www.Brenco-Inc.com](http://www.Brenco-Inc.com).**



**C600-1625 Ground Set**

Electrical Ratings			
Cat #	G3622-1	G1810-2	T600-0806
Continuous Current Amps	400	300	400
Fault Current 15 Cycles	43,000	28,000	43,000
Fault Current 30 Cycles	30,000	20,000	30,000
Mechanical Ratings			
Recommended Torque in lbs	250	250	250
Main Line Range Max.	1.162"	0.574"	1.625"
Main Line Range Min.	0.162"	0.162"	0.5"
Jumper Range Max.	4/0 Ground	2/0 Ground	4/0 Ground
Jumper Range Min.	#2 Ground	#2 Ground	#2 Ground
Weight Each lbs	1.5	1.5	1.75
ASTM Designation	Type 1 Cl. A Grade 5	Type 1 Cl. A Grade 3	Type 1 Cl. B Grade 5

**Tower & Flat Face Clamps**



**T600-1798** Aluminum Body, Serrated Jaws, Bronze T-Handle, Threaded Type



**C600-2232** Bronze Body, Serrated Jaws, Bronze Eyescrew, Threaded Type



**G3363-3SJ** Aluminum Body, Serrated Jaws, Bronze Eyescrew, Pressure Type



**C600-1735** Aluminum Body, Serrated Jaws, Bronze Eyescrew, Threaded Type



**C600-2231** Bronze Body, Serrated Jaws, Bronze T-Handle, Threaded Type



**G3363-4SJ** Aluminum Body, Serrated Jaws, Bronze T-Handle, Pressure Type



**G3363-1** Bronze Body, Serrated Jaws, Bronze Eyescrew, Threaded Type



**G3363-2** Bronze Body, Serrated Jaws, Bronze T-Handle, Pressure Type



**G4229-1SJ** All Angle, Grounding Clamp, Pressure Type



Electrical Ratings			
Cat #	T600-1798	C600-2232	G3363-3SJ
Continuous Current Amps	400	400	400
Fault Current 15 Cycles	25,000	43,000	25,000
Fault Current 30 Cycles	25,000	30,000	25,000
Mechanical Ratings			
Recommended Torque in lbs	250	250	250
Main Line Range Max.	1.5"	1.5"	1.5"
Main Line Range Min.	0.125"	0.125"	0.125"
Jumper Range Max.	2/0 Ground	4/0 Ground	2/0 Ground
Jumper Range Min.	#2 Ground	#2 Ground	#2 Ground
Weight Each lbs	1.5	2.0	1.625
ASTM Designation	Type III Cl. B Grade 3	Type 1 Cl. B Grade 5	Type 1 Cl. B Grade 3

Electrical Ratings			
Cat #	C600-1735	C600-2231	G3363-4SJ
Continuous Current Amps	400	400	400
Fault Current 15 Cycles	25,000	43,000	25,000
Fault Current 30 Cycles	25,000	30,000	25,000
Mechanical Ratings			
Recommended Torque in lbs	250	250	250
Main Line Range Max.	1.5"	1.5"	1.5"
Main Line Range Min.	0.125"	0.125"	0.125"
Jumper Range Max.	2/0 Ground	4/0 Ground	2/0 Ground
Jumper Range Min.	#2 Ground	#2 Ground	#2 Ground
Weight Each lbs	1.5	2.0	1.625
ASTM Designation	Type 1 Cl. B Grade 3	Type III Cl. B Grade 5	Type III Cl. B Grade 3



**T600-1922** Penetrator Clamp For Grounding Cable. Special Clamp Ensures Contact With Center Conductor For Underground Distribution Cable

Electrical Ratings			
Cat #	G3363-1	G3363-2	G4229-1SJ
Continuous Current Amps	400	400	400
Fault Current 15 Cycles	25,000	25,000	43,000
Fault Current 30 Cycles	25,000	25,000	30,000
Mechanical Ratings			
Recommended Torque in lbs	250	250	250
Main Line Range Max.	1.5"	1.5"	1.196"
Main Line Range Min.	0.125"	0.125"	0.258"
Jumper Range Max.	2/0 Ground	2/0 Ground	4/0 Ground
Jumper Range Min.	#2 Ground	#2 Ground	#2 Ground
Weight Each lbs	2.5	2.5	2.0
ASTM Designation	Type 1 Cl. B Grade 3	Type III Cl. B Grade 3	Type 1 Cl. B Grade 5

## Ball-and-Socket Design



**C600-2100** with drilled terminal or Clamp  
**C600-2101** With Tapped Terminal (Also Available with T-Handle)

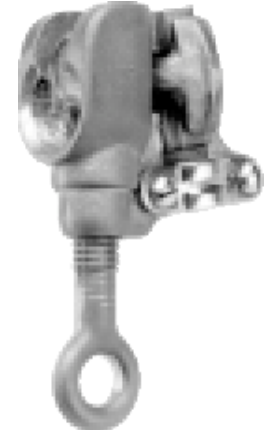

**C600-2300** with Pressure Terminal



**C600-2102** Ball-Stud 4.5" Total Length 2.125" Thread

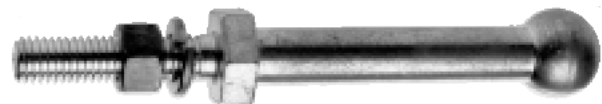

**T600-2364** Ball-Stud, 7" Total Length, 2.75" Thread

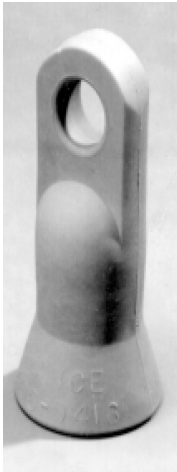

**C406-0416**  
Grounding Stud  
Cover. Fits 1"  
Ball Studs.



**Transformer Grounding Set**



Cat #	Description	Weight Ea.
C600-0729	15kV Single Transformer Grd Set	4 lb
T600-2131	25kV Single Transformer Grd Set	6 lb
C600-1927	35kV Single Transformer Grd Set	8 lb

**Grounded Parking Stand**

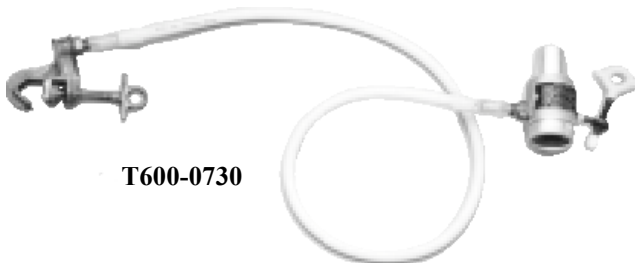

Cat #	Application	Weight Ea
T600-0730	15kV	7 lb
T600-2124	25kV	8 lb

**Overhead Distribution Ground Set.** This complete set of ground clamps, cable and accessories gives all of the equipment needed for many types of distribution structures in one easy-to-use kit. The jumper terminals are crimped to the grounding cable. The Table below lists the various components completely assembled to the distribution grounding set.

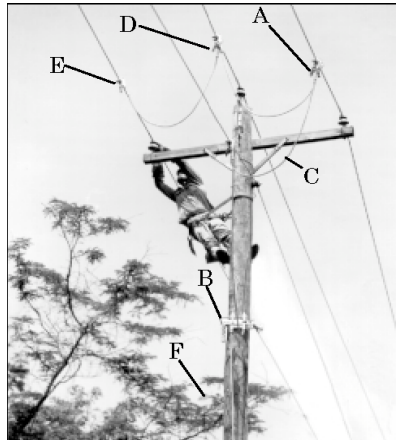

Item	Description	Quantity	Information
A	"C" Clamp Cat #C600-2276	10	For Plug Ferrule
B	Ground Cluster Support	1	Cat #T600-1549
C	#2 Copper Cable	60 ft.	(3) 6' (1) 12' (1) 30'
D	#2 Plain Plug Ferrules	10	C600-2626
E	Clamp Support Stud	3	Cat #G3626
F	Screw Ground Rod	1	Cat #G3370

**Electro-Static Precipitator Grounding Tool Set**



**Grounding Ferrules**

**Plain Plug Copper Shrouded Ferrules**

Cat #	Burndy Die #		Cable Size AWG
	Section A	Section B	
C600-2630	U165	U166	#2
C600-2631	U165	U168	1/0
C600-2632	U165	U-L	2/0
C600-2633	U166	U-L	4/0

**Plain Plug Unshrouded Copper Ferrules**

Cat #	Burndy Die #	Cable Size
C600-2614	U165	#2
C600-2615	U165	1/0
C600-2616	U165	2/0
C600-2617	U166	4/0

**Threaded Shrouded Copper Ferrules**

Cat #	Burndy Die #		Cable Size AWG
	Section A	Section B	
C600-2622	U165	U166	#2
C600-2623	U165	U168	1/0
C600-2624	U165	U-L	2/0
C600-2625	U166	U-L	4/0

**Threaded Unshrouded Copper Ferrules**

Cat #	Burndy Die #	Cable Size
C600-2606	U165	#2
C600-2607	U165	1/0
C600-2608	U165	2/0
C600-2609	U166	4/0

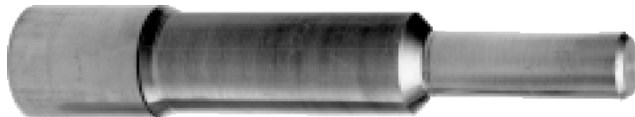

**Shrouded Plain Plug Ferrule**



**Unshrouded Plain Plug Ferrule**

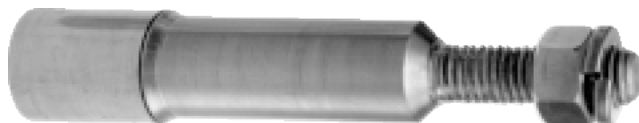

**Shrouded Threaded Plug Ferrule**



**Unshrouded Threaded Plug Ferrule**

**Aluminum Plug Shrouded Ferrules**

Cat #	Burndy Die #		Cable Size AWG
	Section A	Section B	
C600-2626	U165	U166	#2
C600-2627	U165	U168	1/0
C600-2628	U165	U-L	2/0
C600-2629	U249	U-L	4/0

**Aluminum Plug Unshrouded Ferrules**

Cat #	Burndy Die #	Cable Size
C600-2610	U165	#2
C600-2611	U165	1/0
C600-2612	U165	2/0
C600-2613	U249	4/0

**Aluminum Threaded Shrouded Ferrules**

Cat #	Burndy Die #		Cable Size AWG
	Section A	Section B	
C600-2618	U165	U166	#2
C600-2619	U165	U168	1/0
C600-2620	U165	U-L	2/0
C600-2621	U249	U-L	4/0

**Aluminum Threaded Unshrouded Ferrules**

Cat #	Burndy Die #	Cable Size
C600-2602	U165	#2
C600-2603	U165	1/0
C600-2604	U165	2/0
C600-2605	U249	4/0

**Support Studs for Pressure-Terminal Clamps**



**G3626 For Rear Mount**





**G3627** For Side Mount

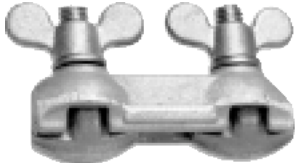

**T600-0252** Cable Splice

**G4754-1** Terminal Block, for Plain Ferrules



**C600-0152** Cluster Support, 1-Terminal Type

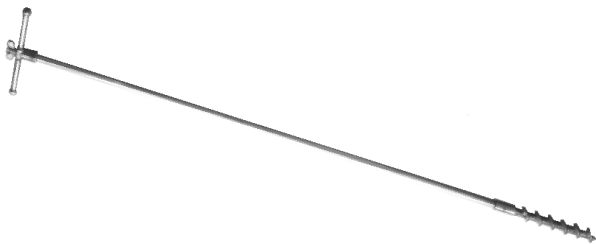

**G3370** Temporary Ground Rod

**If you do not see something you are looking for, please call us!**

[www.Brenco-Inc.com](http://www.Brenco-Inc.com)

**Conductor & Cleaning Tools**



**4112** V-Type Hand Held Cleaning Brush

**4110** Hand Held Cleaning Brush Comes in 2.5" and 5"

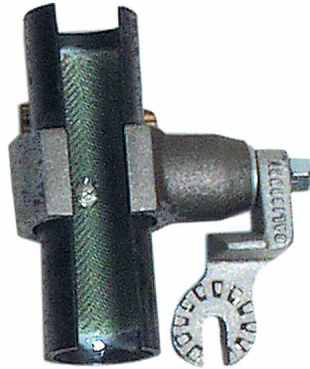

**4108** Universal Tubular Cleaning Brush

**4111** Universal V-Type Cleaning Brush

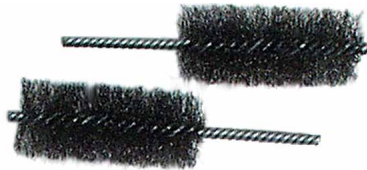

**4113** Replacement Cleaning Brush V-Type 10 Pack

**Voltage Detectors**

Voltage detectors are used to verify live or de-energized conductors. These testers may be used with rubber insulating gloves or hot sticks using the splined universal end fitting. Each tester has a 4.5 volt transistor amplifier with an audio/visual indicator.

